



9 College Lane Flats, Littlemore, Oxford, OX4 4LJ

Location: Littlemore
Floor: Ground floor
Bedrooms: 1 (double)
Lounge: Spacious
Kitchen: Includes all appliances
Bathroom: With shower over bath
Parking: Available
Gardens: Rear communal gardens
Suitability: Professional couple or single
Council Tax Band: B

Located in the quiet area of Littlemore, this ground floor flat offers spacious and comfortable living. The property features a generously sized lounge, a fitted kitchen with appliances, a double bedroom, and bathroom with a shower over the bath. Parking is available, and tenants can enjoy the use of rear communal gardens. Ideal for a professional couple or single occupant, this property offers convenience and comfort in a peaceful setting. With its council tax band B classification, it presents an attractive option for those seeking a well-appointed residence.

- 1 Bedroom
- 1 Reception
- 1 Bathroom
- Littlemore
- Furnished Property
- Council tax band B

£1,075 PCM

GROUND FLOOR

APPROX. 42.6 SQ. METRES (458.4 SQ. FEET)

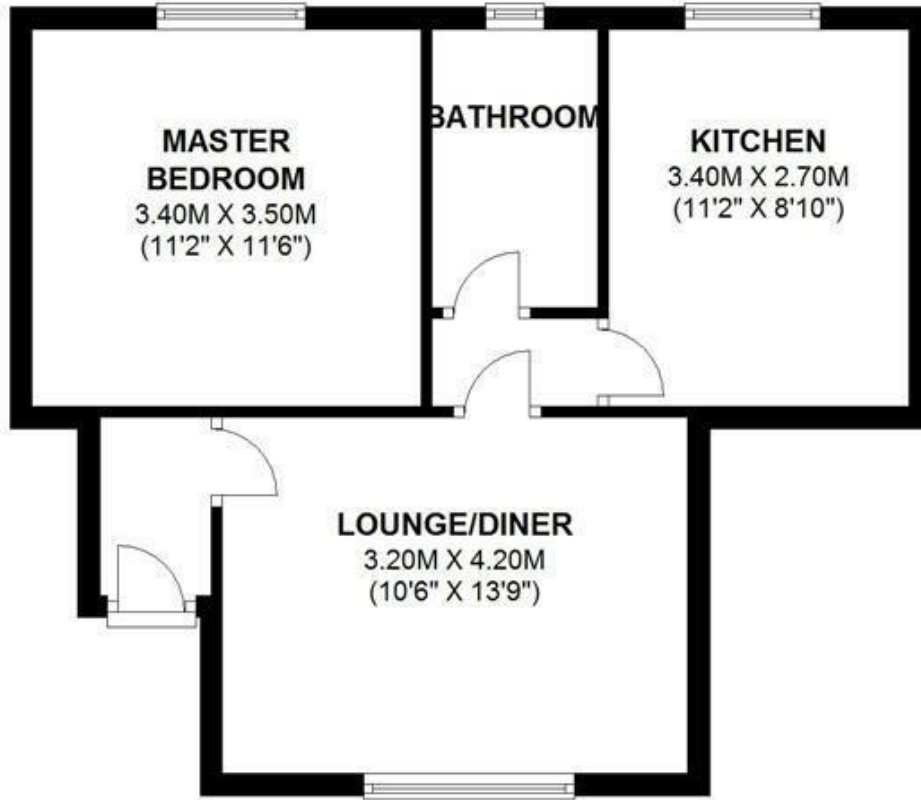

TOTAL AREA: APPROX. 42.6 SQ. METRES (458.4 SQ. FEET)

